

**INDIAN CREEK
LIBRARY**

16100 W 135TH ST
OLATHE, KS 66062
CITY PROJECT NUMBER
6-C-001-17

owner:
CITY OF OLATHE
100 E Santa Fe Street
Olathe, KS 66061

architect:
Gould Evans
4041 Mill Street
Kansas City, MO 64111
816.931.6655
www.gouldevans.com

consultant:
Group A Architecture
211 Linden Ave
South San Francisco, CA 94080
650.871.0709

structural engineer:
Bob D. Campbell
4238 Bellview Avenue
Kansas City, MO 64111
816.531.4144

map engineer:
Smith & Boucher Inc.
25501 Valley Parkway
Suite 200
Overland Park, KS 66061
913.345.2127

civil engineer:
SK Design Group Inc.
4600 Cottage Boulevard
Suite 100
Overland Park, KS 66211
913.451.1818

landscape architect:
Gould Evans, P.A.
4041 Mill Street
Kansas City, MO 64111
816.931.6655

a/v technology:
The Sextant Group
2296 Henderson Mill Rd NE
Suite 116
Atlanta, GA 30345
404.371.8080

a/v technology:
Carson Block Consulting, Inc.
2913 Michener Ct
Fort Collins, CO 80526
970.673.7475



Gould Evans
Dennis Strait Date: 08/24/2018
Architect License No. 5526

REVISIONS		
NUMBER	DESCRIPTION	DATE

PROJECT NO: 0217-1020
DATE: 08/24/18

FURNITURE PLAN
LEVEL 1

IF101

GMP Conformance Set

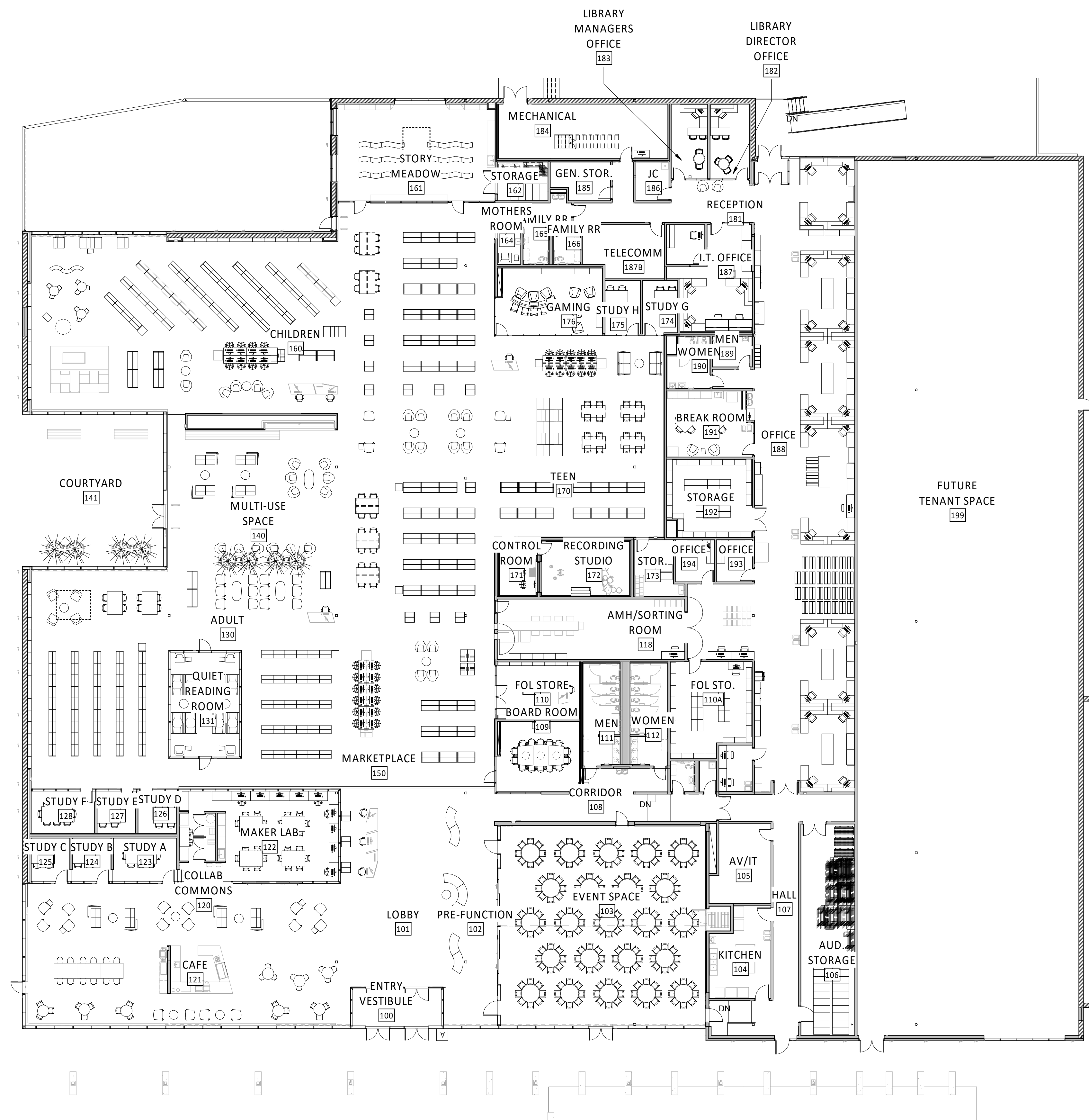

FURNITURE PLAN LEVEL 1 **A4**

1/16" = 1'-0"